

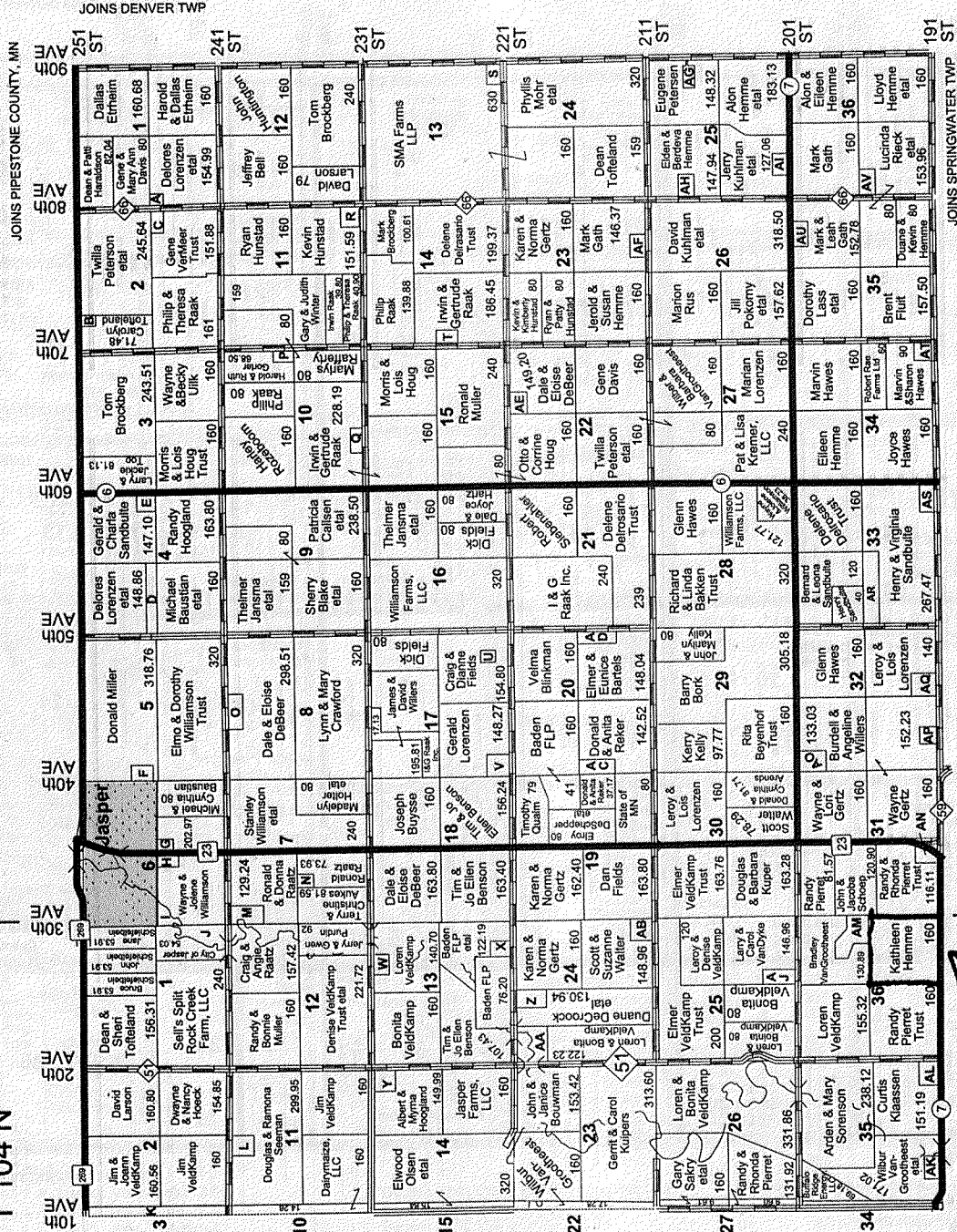

ROSE DELL TWP LAND OWNER

R 47 & 46 W

T 104 N



- Small Tracts**
- Section 1E A Travis & Amanda Ockenga - 5.01
 - Section 2E B New Horizons Farms LLP - 6
 - Section 4 C Michael & Jennifer Melcher - 7.12
 - Section 5 D Michael & Cynthia Baustian - 10.02
 - Section 6 E Vernon & Gloria Brouwer - 9.11
 - Section 7 F.G. Everski Inc. - 6.68
 - Section 8 G Charles & Colette DesCherrier - 7.99
 - Section 9 H Arnold & Judy Callisen - 9.22
 - Section 10 I Kevin & Shelia Mathiesen - 9.22
 - Section 11 J Wayne Williamson etux - 23.95
 - Section 12 K Janice Sneller - 6.60
 - Section 13 L Aaron Olund etal - 20.05
 - Section 14 M Craig & Angie Raatz - 19
 - Section 15 N William Roffs - 7.65
 - Section 16 O Curtis & DeaAnn Aro - 21.49
 - Section 17 P H.R.G. Raak Inc. - 7.34
 - Section 18 Q R. Kavin & Kimberly Hunstad - 8.41
 - Section 19 R S New Horizons Farms LLP - 9.99
 - Section 20 S T.R.G. Raak Inc. - 8.18
 - Section 21 U Douglas Lorenzen - 5.20
 - Section 22 W Joel & Rosemarie Harris - 11
 - Section 23 X Larry & Kristie Fjellanger - 6
 - Section 24 Y Jeffrey Banda - 29.06
 - Section 25 Z Adam Scholl - 31.64
 - Section 26 AA Nora Walter - 11.04
 - Section 27 AC Dawn & Nancy Pals - 17.48
 - Section 28 AD Elmer & Eunice Barrels - 11.96
 - Section 29 AE Ivan & Debra VanSursum - 10.80
 - Section 30 AF Thomas & Sandra Clark - 13.63
 - Section 31 AG Bradley & Heather Palersen - 8.25
 - Section 32 AH Arnold & Judy Callisen - 12.06
 - Section 33 AI Neale Hamann - 9.81
 - Section 34 AJ Tami Bork - 13.04
 - Section 35 AK Roger & Teri Wasson - 6.19
 - Section 36 AL Byron & Sheryl Klaassen - 6.55
 - Section 37 AM Deanna Lee - 33.48
 - Section 38 AN Benson Family Trust - 5.60
 - Section 39 AO Ronald & Loreta Osenga - 25.97
 - Section 40 AP Matthew Steinhoff - 7.77
 - Section 41 AQ Glenn & Dianne Lorenzen - 20
 - Section 42 AR Henry & Willis Sandbulte - 40
 - Section 43 AS Brian Gramman - 12.53
 - Section 44 AT Vincent & April Brouwer - 10
 - Section 45 AU Gene & Barbara Hamann - 7.22
 - Section 46 AV Shelly & Mark Ahlschlaeger - 6.04

R 47 W	R 46 W	R 45 W	R 44 W
ROSEDELL	DENVER	BATTLE PLAIN	VIENNA
SPRINGWATER	MOUND	VIENNA	MAGNOLIA
BEAVER CREEK	LUVIERNE	MAGNOLIA	KAMARAZKI
MARTIN	CLINTON	KAMARAZKI	
			T 101 N
			T 102 N
			T 103 N
			T 104 N

All material in this book is protected by U.S. copyright law. Any reproduction, in whole or part, will be prosecuted.

ROCK COUNTY, MN